

Flasher Button

Designed for medium base sockets.
Flash rate 65-85 per minute.

120V 60W



28225

Don't wait!

Hurry and check out
all the great parts at,
City Lights OEM

Nut & Threadlocker

Medium strength
general purpose
threadlocker.
Removable with
hand tools.

26160 -50ml

23785 -10ml



Dusk to Dawn Automatic

Halogen PAR 38 Flood
130V E26 90W

Built in Photo Cell



23790

You can cut energy costs up to 40%,
get improved whiter, brighter light,
and use the lamp for :

- > Outdoor security lighting
- > Driveways
- > Walkways
- > Landscape lighting

Average lamp life is 3,000 + hours



Stop the Sticking

Special lubricant prevents bulbs,
fuses & batteries from
sticking in sockets.

A new product that solves
an old problem

23658

Non-toxic.
Prevents corrosion
Use with any style bulb or fuse.
Prevents oxidation & electrolysis.
Not recommended for halogens.



CITY LIGHTS INC.

3911 W Van Buren #3 Phoenix, AZ. 85009

Phone: 602 233 2552

Fax: 602 233 1102

www.citylightsphx.com

2 Electronic Transformers



26086 -60W 24707 -75W



120VAC 60Hz 12VAC
Auto reset protected. Use with 12V halogen lamps (dimmable)

2-1/2"x1-3/8"x7/8"

24457 -150W 24976 -105W

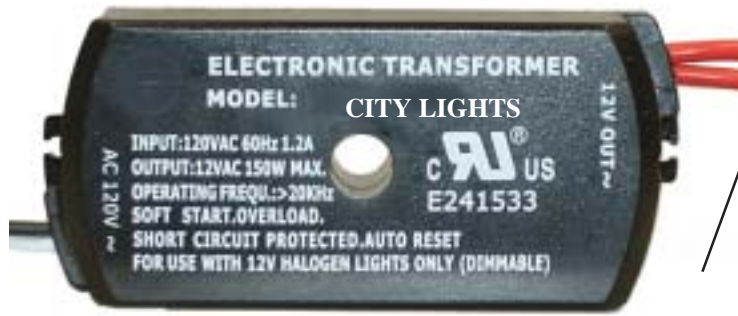

120VAC 60Hz 12VAC
Short circuit protected. Auto reset Dimmable. 4-3/8"x1-7/8"x1-1/4"

Electronic Energy Saver Circline Ballasts

UL & cUL

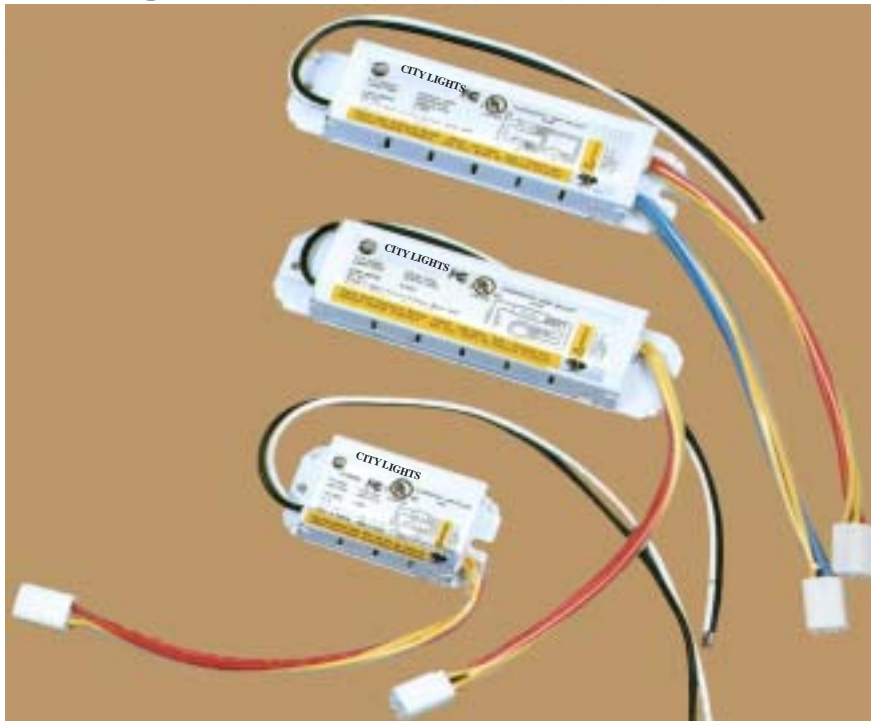

ITEM	WATTS	INPUT VOLTAGE	NO.OF LAMPS	LAMP TYPE	SIZE L-W-H
24602	22W	120V	1	FC8T9	2 3/4"x1 11/16"x1 5/16"
21529	32W	120V	1	FC12T9	6 3/8"x1 11/16"x1 5/16"
22413	54W	120V	2	FC8T9/FC12T9	6 3/8"x1 11/16"x1 5/16"
22562	72W	120V	2	FC12T9/FC16T9	6 3/8"x1 11/16"x1 5/16"

Rapid Start, High Power Factor, Class P.

CITY LIGHTS INC. Phone: 602 233 2552
Fax: 602 233 1102

3911 W Van Buren #3 Phoenix, AZ. 85009 www.citylightsphx.com

Compact Fluorescent Electronic Ballasts



side view



bottom view



Magnetic Ballasts

120 V 60HZ

Preheat Self Start

Normal Power Factor

Type 1



10953

For (1)-F4T5-F6T5-F8T5

15041 - 1 or 2 42W cfl's

Features:

- Program start.
- Multi volt 120 thru 277 and designated 347V.
- 50/60 Hz.
- UL & CSA listed.
- End of life detection & shut down circuit.
- Starting temp. -4°F/-20°C.
- No PCB's.
- Encased & potted.
- Remote mounting 18 ft.
- High power factor.
- Dual entry poke-in connectors side & bottom.

14973 - 1 or 2 13W cfl's

12241 - 1 or 2 18W cfl's

10900 - 1 or 2 26W or 1-32W or 1- 42W cfl's

Features:

- Pre-heat, Rapid start.
- High power factor.
- Dual entry poke-in connectors side & bottom.
- Inherent thermal protection.
- Type 1 outdoor.
- End of lamp life circuit protected.
- 120-277 volts 50/60 Hz.
- UL & CSA listed.
- Auto restart with relamping.
- White metal case.
- Acceptable for use in residential lighting fixtures.
- No PCB's.
- Encased & potted.
- Starting temp -4°F/-20°C
- Compatible with leading manufacturers of emergency battery packs

11102

For (1)- F12-14-15-16-18-19T8 or F14-15-20T12 also FC6T9-FC8T9

CITY LIGHTS INC.

3911 W Van Buren #3 Phoenix, AZ. 85009

Phone: 602 233 2552

Fax: 602 233 1102

www.citylightsphx.com

4 Hardware Items



Steel Nipples

Zinc Plated 1/8 IPS

- 
- 1/2" -27145
 - 3/4" -22415
 - 1" -27126
 - 1-1/4" -22007
 - 1-1/2" -24501
 - 1-3/4" -26101
 - 2" -27110
 - 2-1/4" -25894
 - 2-1/2" -26107
 - 3" -26139
 - 3-1/2" -27119
 - 4" -26098
 - 4-1/2" -27104
 - 5" -26108
 - 5-1/2" -26132
 - 6" -27146
 - 36" -27125

Steel Nipples

Zinc Plated 1/4 IPS

- 
- 1" - 26114
 - 3" - 27112
 - 4" - 26128
 - 5" - 27135
 - 36" - 26123

Steel Nipple

(all thread)

Zinc Plated
3/8 IPS x 36"
26134



Steel Pal Nut 1/8 IP



27109 -unf.
28110 -brass plated

Brass Plated Steel Lockwasher 1/8 IP slip



28118

Solid Brass Unfinished Hex Nut 1/8 IP



1/2" x 1/8" thick

28107

Steel Hex Nuts 1/4 IP



29251

unfinished
3/4" x 1/4" thick

29095

unfinished
11/16 x 1/8" thick

Steel Hex Nut 1/8 IP

9/16" x 1/8" thick



27150 -unf.
26124 -z/p

Steel Hex Nut 1/8 IP

9/16" x 3/16" thick



27147 -unf.
26105 -z/p

1/8 IP x 1" Steel Washer



29260 -brass plated

1/8 IP Caps



29233 -brass

29265 -chrome

Brass Cord Bushing



29237 -1/8IP

Steel Lockwasher 1/4 IP

29315
unfinished



Stamped Steel Hickey



29277 -1/8 x 1/8 x 5/8

29215 -1/8 x 1/8 x 1

25625 -1/8 x 1/8 x 1-1/2 (straight)

Brass Reducer Bushings

28235 - 1/8IP x 8/32

29140 - 1/4IP x 1/8IP



White Plastic Caps 1/8 IP



26135

CITY LIGHTS INC. Phone: 602 233 2552

Fax: 602 233 1102

3911 W Van Buren #3 Phoenix, AZ. 85009 www.citylightsphx.com

1/8 IP Gem Bar



3/4" x 3-7/8"

27153 -z/p

1/8 IP Gem Bar with Grd. screw



3/4" x 3-7/8"

27129 -z/p

Offset Cross Bar with Grd. screw



1" x 4"

Holes
2-3/4", 3-3/8" & 3-1/2"
center to center

26115 -z/p

1/4 IP Cross Bar with Grd. screw



1" x 4-3/8"

28100 -z/p

Universal Crossbar



Holes:
2-3/4" & 3-1/2"
center to center

28104 -z/p

Universal Circle Crossbar



Holes: 2-3/4" & 3-1/2"
center to center

26140 -z/p

**Hex Head
Ground Screw**

8/32 tap



29115 - green

Hex Head Nipples

1/8 IPS male thread
zinc plated



23564 -3/8"
23967 -1/2"

3/8 IP Cross Bar

27254 -z/p



1" x 4-3/8" with 8/32 grd. screw hole

CITY LIGHTS INC.

3911 W Van Buren #3 Phoenix, AZ. 85009

Phone: 602 233 2552

Fax: 602 233 1102

www.citylightsphx.com

6 Poles & Accessories



5-1/4" Cast Aluminum Neckless Post Fitter w/ porcelain socket

Fits 3" poles

26104



5-1/4" Post Top Fitter Kits

Aluminum.....26119

Polycarbonate... 23700



3" Black Round Steel Direct Burial Poles



27116 -7 foot

27141 -10 foot

27164 -12 foot

4"

X

4"

23736 -15ft.

27122 -20ft.

23840 -25ft.

**11 ga. carbon steel pole
4"x 4" sq.
Bronze color**

**Includes:
Hand hole
Base cover
Top cap
Anchor base w/four slotted holes
Bolt circle 8" thru 11-1/4"**

5-1/4" Neckless Polycarbonate Post Fitter w/ porcelain socket



23695

Fits 3" poles



**120V 1000W
Photo Cell**

27121

J-Bolts 30" Long

Includes:
2 Hex nuts
2 Heavy washers
1 Locknut

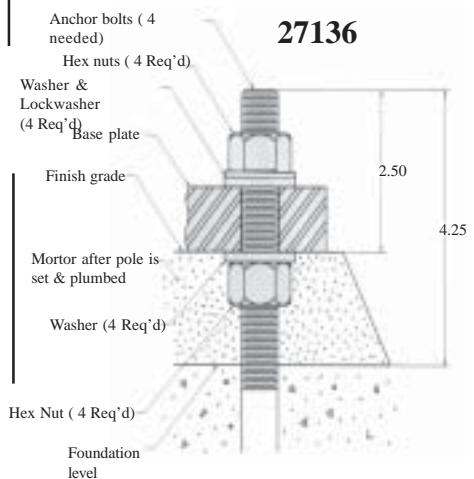

27136

CITY LIGHTS INC.

Phone: 602 233 2552

Fax: 602 233 1102

3911 W Van Buren #3 Phoenix, AZ. 85009

www.citylightsphx.com

Polyethylene

Necked

25951 -6"x 3-1/4"
25892 -12"x 4"

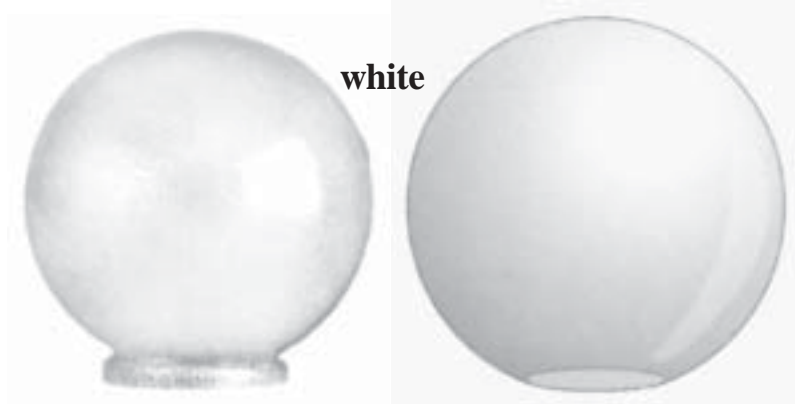

white

Neckless

26186 -12"x 5-1/4"
23780 -16"x 5-1/4"

Polycarbonate (Lexan)

Necked

26191 -6"x 3-1/4"
29306 -12"x 4"

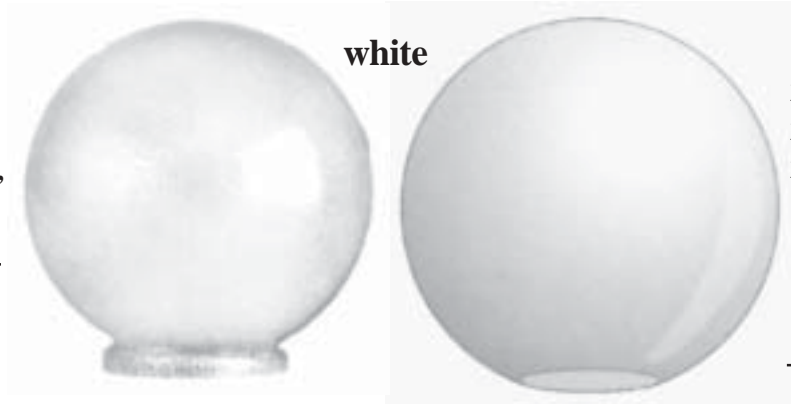

white

Neckless

26193 -12"x 5-1/4"
29279 -14"x 5-1/4"
29284 -16"x 5-1/4"

Clear

26194 -12"x 5-1/4"
26198 -16"x 5-1/4"

Acrylic

Necked

29173 -6"x 3-1/4"
29185 -12"x 4"

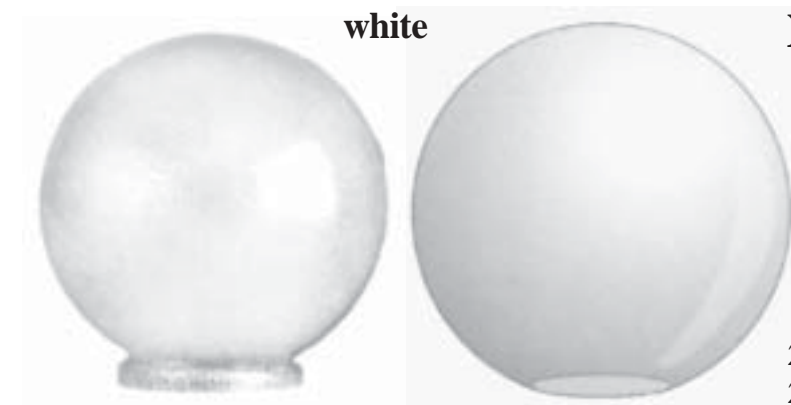

white

Neckless

26096 -12"x 5-1/4"
29143 -14"x 5-1/4"
29203 -16"x 5-1/4"

Clear

29217 -12"x 5-1/4"
29247 -16"x 5-1/4"

CITY LIGHTS INC.

3911 W Van Buren #3 Phoenix, AZ. 85009

Phone: 602 233 2552

Fax: 602 233 1102

www.citylightsphx.com

8 Ornamental & Other Globes



Washington



color
clear

Jefferson



Hey Guy's!
We got poles too.

Polycarbonate

24720

21.37" high
14" wide,
8" fitter

24738

24.75" high
16.60" wide,
9.12" fitter

Acrylic

25347

21.37" high
14" wide
8" fitter

23635

24.75" high
16.60" high
9.12" fitter

Polycarbonate

24561

23.25" high
15.25" wide
8" fitter

Acrylic

25115

23.25" high
15.25" wide
8" fitter

*Special shapes and sizes
available on special orders.*



Acrylic Cylinders

(white)

neck threaded 3-11/64



25520 -7" high

25670 -8" high

Call now

In stock

To-day

Yes we can

CITY LIGHTS INC.

Phone: 602 233 2552

Fax: 602 233 1102

3911 W Van Buren #3 Phoenix, AZ. 85009

www.citylightsphx.com

Metal Shell Lampholders

2-Circuit 3 Terminal

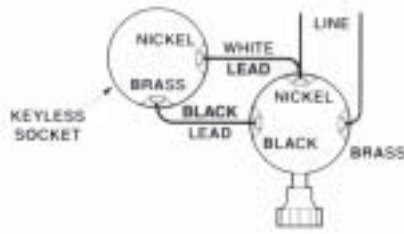

Uses single-filament lamp. Wired in series with a keyless socket, single-filament lamp. Switch controls both single-filament lamps in a sequence of:

- (1) keyless ON **26120 -Leviton**
- (2) 26120 ON
- (3) both ON
- (4) both OFF

All are Polished Gilt color
All have 1/8 IPS Cap

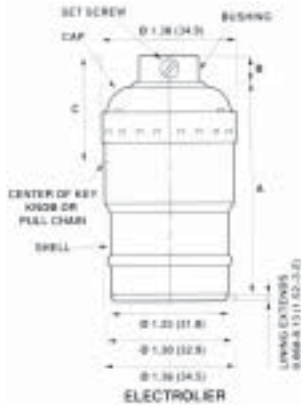

- Electrolier
- Removable Turn knob
- Polished gilt (color)
- Cap has set screw
- 250W-250V



3-Way (2 Circuit)

27107 -Leviton

For a 2-filament lamp
LOW-MEDIUM-HIGH-OFF

Push-thru Bar, Single Circuit



660W
250V

27137 -Leviton

1-Way (Single Circuit)

27152 -Leviton

Keyless single circuit



660W
250V

Short electrolier size

28102 -Import Only

Pull Chain Single Circuit



660W
250V

28115 -Leviton

Heavy Cast Brass Polished Socket



26094 -1-way

28105 -3-way

250W
250V

4 piece socket set:
shell, cap with set screw,
interior & ring

Base designations;
Standard, Edison, Medium
& *E26* all mean the same size,
1" diameter.
Candelabra & *E12* are
1/2" diameter.

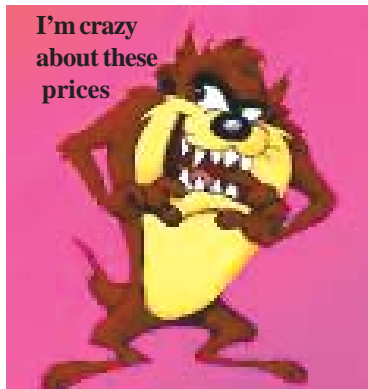

CITY LIGHTS INC.

3911 W Van Buren #3 Phoenix, AZ. 85009

Phone: 602 233 2552

Fax: 602 233 1102

www.citylightsphx.com

10 Mogul & Pulse Rated



Designed for Open-fixture lamps



**Mogul
Pulse Rated**

28112 -4KV **Leviton**
1500W-600V (2) 8/32 screws 200°C leads

*Fits MP style
lamps only*

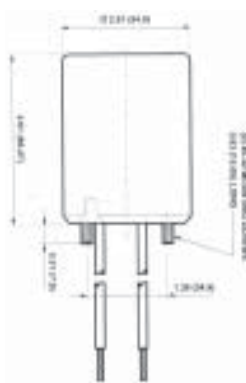

Position Oriented



**Mogul
Pulse Rated**

26117- 4KV **Leviton**
200°C leads & wireway
1500W-600V (2) 8/32 screws

Mogul Pulse Rated



1500W-600V

28125 -4KV -import
w/ (2) 8/32 nuts

wireway with 200°C leads

27120 -4KV -import
w/(2) 8/32 screws



Non-Pulse Rated Mogul with Screw Terminals

screw terminals set in deep
wire wells

1500W-600V

25963 -(2) 8/32 lock nuts
Leviton

25652 -(2) 10/32 screws



Medium Base Pulse Rated Sockets

600W-600V

2-18ga.
9" SF-2 leads
200°C

28113 -4KV **Leviton**
(2) 6-32 bushings

23871 -4KV **Leviton**
(2) 6-32 screws

26125 -4KV **Leviton**

23842 -4KV import w/ leads

23665 -4KV import
(2) 6-32 screws
18" SF leads

24160 -4 KV import
(2) 6-32 nuts, 9" leads

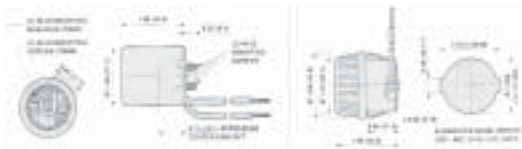

Mogul 5 KV Pulse Rated



23877
Leviton

1500W-600V
(2) 8-32 screws

24358
import
leads 12",
14AWG 200°C

CITY LIGHTS INC. Phone: 602 233 2552
Fax: 602 233 1102

3911 W Van Buren #3 Phoenix, AZ. 85009 www.citylightsphx.com

Pony Cleat Medium Base Square

660W-250V

Brown phenolic body
Aluminum screw shell

26116 -Leviton



Two-Piece Porcelain Ring-Type

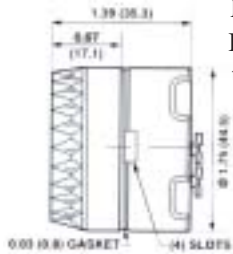

Medium base
Bottom screw
terminals

660W-250V

26109 -Leviton
24149 -import



One-Piece Snap-In

Porcelain body
screw terminals

13924

660W-250V



HID Light Fixture Tester



20105 -mogul base (pictured above)

20203 -medium base

Tests HPS, MH, Pulse Start MH & Mercury lamps
Medium base tests up to 175 Watts Mogul base tests up to 1000 Watts

One -piece Shallow Back

Porcelain body
Screw terminals
Tempered steel mounting clip

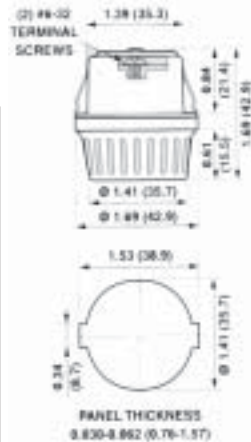

23794 -import

26126 -Leviton

Medium base

Pony Cleat Round Candelabra Base

White urea Aluminum screw shell

75W-125V

2 mounting holes
1-1/8" Ctr to Ctr
for #4 screws



27130 -Leviton

Die-Cast Mogul Cap



28111

cap is threaded 1/2" IPS, furnished with insulator,
mounting holes are tapped 8-32 on 1-3/8" centers

CITY LIGHTS INC.

3911 W Van Buren #3 Phoenix, AZ. 85009

Phone: 602 233 2552

Fax: 602 233 1102

www.citylightsphx.com

12 Import Sockets



Straight Porcelain Body



660W-250V

1/8 IP
metal cap
w/set screw

Medium
base

23660

23793 -24" leads

2-Hole Porcelain Flange Socket

Flange diameter is 2" x 1/2" thick,
two 8/32 holes spaced on 2: centers

600W-600V

screw terminals
Medium
base

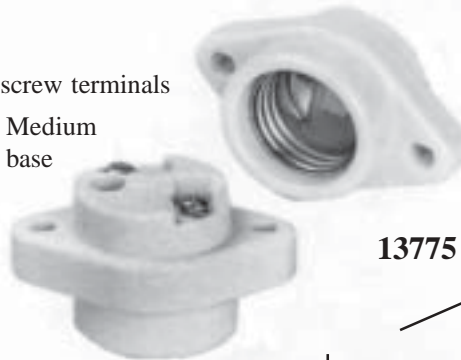

13775

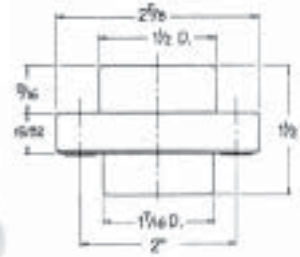

3 Terminal Porcelain



660W-250V

1/8 IP
metal cap
w/set screw

Medium
base

27117

Twin Porcelain

1/8 IP cap screw terminals

26112

9" leads

23818



Medium
base

660W-250V

Twin Porcelain with Bracket

660W-250V

1/8 IP bracket

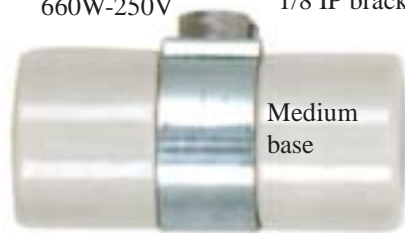

Medium
base

27128

screw terminals

Intermediate Porcelain



75W-250V

1/8 IP hickey

8" leads
single leg
pull thru

26099

Two Piece Porcelain Sign

660W
250V

Medium
base

26121

2 leads
AWM
105°C



Two Piece Porcelain Sign

Internal screw terminals

660W-250V



Medium
base

27139

Porcelain Side Mount



1/8 IP
screw
terminals
23885

9" leads
23632

660W-250V

Porcelain Hickey 1/8 IP



Medium base

660W
250V

screw
terminals

23685

All sockets are of the highest quality. All are UL listed. Can be shipped in 24 to 48 hours. Most are in stock now.

CITY LIGHTS INC. Phone: 602 233 2552 Fax: 602 233 1102

3911 W Van Buren #3 Phoenix, AZ. 85009 www.citylightsphx.com

Automatic Photo Controls

23702

Turns on at dusk and off at dawn.
120V-150W
Inside and outside use.
Compact design fits most smaller enclosed outdoor fixtures.



23652

Compact light control.
Allows you to use *candelabra bulbs*.
Turns on at dusk and off at dawn.
Ratcheting base.
120V-60W



23822

Adjustable light sensor.
Turns lights on at dusk and off at dawn.
120V-150W
Can be used outdoors in an enclosed fixture.



Tube Guards

T12-8ft

23664 -red
24150 -blue
23681 -bug yellow
23874 -clear
23879 -non uv

T12-4ft

24163 -red
25569 -blue
23676 -bug yellow
23670 -clear
23668 -non uv

T8-8ft

23789 -red
23886 -blue
23671 -bug yellow
23682 -clear
23696 -non uv

T8-4ft

23677 -red
25513 -blue
23687 -bug yellow
24162 -clear
24366 -non uv

T5-4ft

23883 -red
23686 -blue
24148 -bug yellow
24152 -clear

Sold in Standard Packs Only

T12...24
T8....48
T5....125
T10...25

End caps included with all tube guards

Many other colors available with special orders

Man! these guards are tough



CITY LIGHTS INC.

3911 W Van Buren #3 Phoenix, AZ. 85009

Phone: 602 233 2552

Fax: 602 233 1102

www.citylightsphx.com



14 CFL GU24 Combo Units



Twist Lock GU24 Four Pin Ballasts

Ballasts --- 24593 -13W --- 25230 -18W --- 27280 -26W --- 27281 -32W UL & cUL



**Watch for dimmable
13-18-26 & 32 watt
ballasts in January
of 2008**

Bulbs not included (sold separately)

GU24 Sockets



Other GU24 sockets available on page 62

29545 white color

23869 Hickies are 1/8 IP

29560

Sockets sold separately

Threaded GU24 hanging type socket



29510



Threaded nut not included (sold separately)

29525

Threaded nut for above socket 52mm O.D.

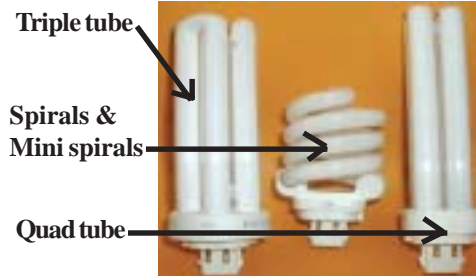

GU24

Socket Adapter converts a standard medium base socket to a GU24 base 29561

GU24 permanent locking adapter also available. 23469

4 Pin Bulbs

- 27176.spiral 13w 2700
- 27190.spiral 13w 3500
- 27187.spiral 13w 4100
- 26087.spiral 18w 2700
- 27101.spiral 18w 3500
- 27255.spiral 18w 4100
- 28124.spiral 26w 2700
- 27195.spiral 26w 3500
- 29106.spiral 26w 4100
- 24595.spiral 13w 2700 mini
- 24603.spiral 13w 3500 mini
- 24607.spiral 13w 4100 mini
- 24719.spiral 18w 2700 mini
- 24977.spiral 18w 3500 mini
- 25106.spiral 18w 4100 mini
- 24861.spiral 26w 2700 mini
- 25348.spiral 26w 3500 mini
- 25239.spiral 26w 4100 mini
- 25517.triple tube 13w 2700
- 24736.triple tube 13w 3500
- 25620.triple tube 13w 4100
- 25521.triple tube 18w 2700
- 25653.triple tube 18w 3500
- 29234.triple tube 18w 4100
- 15015.triple tube 26w 2700
- 15869.triple tube 26w 3500
- 14626.triple tube 26w 4100
- 14087.quad tube 13w 2700
- 10266.quad tube 13w 3500
- 10564.quad tube 13w 4100
- 12501.quad tube 18w 2700
- 12650.quad tube 18w 3500
- 12799.quad tube 18w 4100
- 10915.quad tube 26w 2700
- 11213.quad tube 26w 3500
- 14927.quad tube 26w 4100

CITY LIGHTS INC. Phone: 602 233 2552 Fax: 602 233 1102

3911 W Van Buren #3 Phoenix, AZ. 85009 www.citylightsphx.com

High Output 800ma and 1500ma for 20Ga. Panel

Slide-on Shallow Base for
Power Groove and
Jacketed lamps R17d base

Slide-on Shallow Base for
T-8 & T-12 R17d base

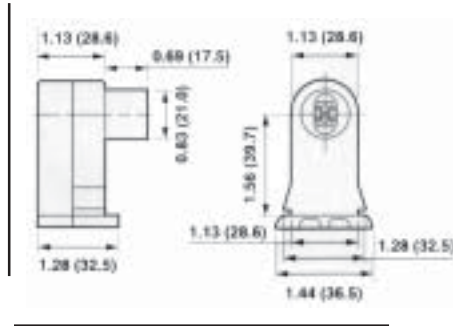

26127
plunger

660W
600V



26110
plunger

660W
600V



26136
fixed



27113
fixed

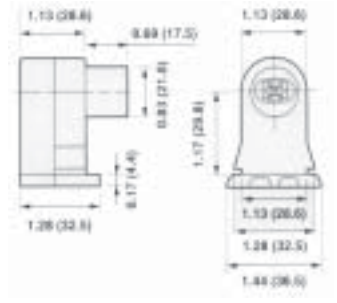

T5 Mini Bi-pin up to 600V

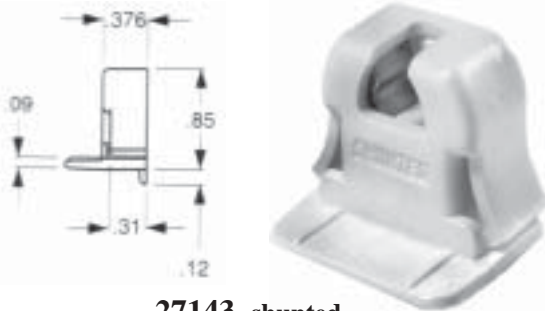

27143 -shunted
Cutout size: .376 x .772

T5 Mini Bi-pin up to 600V

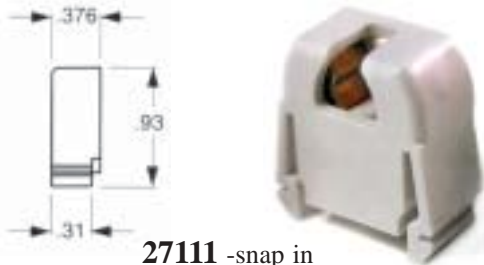

27111 -snap in
Cutout size: .315 x .710

T5 Mini Bi-pin up to 600V

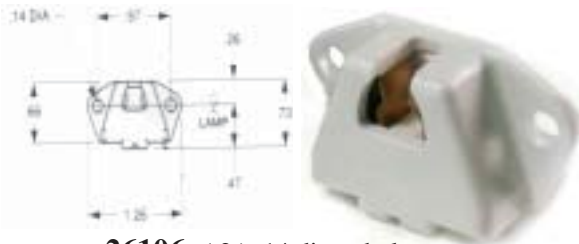

26106 -(2) .14 diam. holes
Mounting holes .97 C to °C

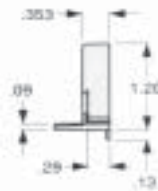

T8 Medium Bi-pin

Cutout size: .353 x 1.016



27134 -standard



27144 - shunted

CITY LIGHTS INC.

3911 W Van Buren #3 Phoenix, AZ. 85009

Phone: 602 233 2552

Fax: 602 233 1102

www.citylightsphx.com

16 Fluorescent Sockets



Medium Bi-pin Low Profile 600W-600V
T-8 and T-12

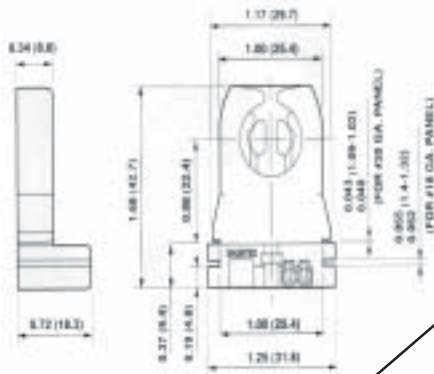

18 & 20 ga. panel mount

28109 -G13

22674 -G13 -Shunted

Medium Bi-pin Straight-in
Low Profile T-8 & T-12 600W-600V



26100 -G13 -shunted

Medium Bi-pin for U-shape
T-8 & T-12 Self aligning
 slide-on for 18 or 20 ga. panel mount



600W
 600V

26137 -G13

Medium Bi-pin Tall Profile 600W
T-8 & T-12 Turn Type 600V

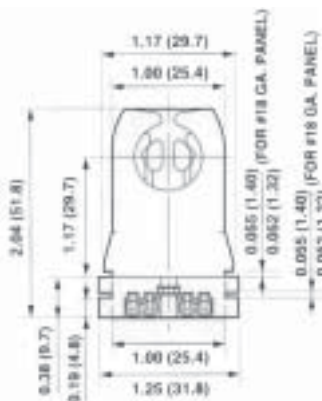

28101 -G13

27108 -G13 -shunted

Miniature Bi-pin
Standard T-5



75W-250V 6" leads

26111 -G5

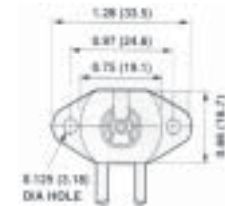

600W-600V

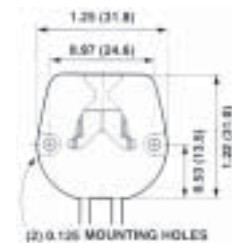

Rapid Start for
T-8 & T-12
 9" leads, Mounting holes
 tapped 4-36.
 Includes 2 4-36 screws.



28106 -G13

28120 **Shallow-base Slide-on**
T-8 & T-12 Lock-on Feature

660W
 1000V

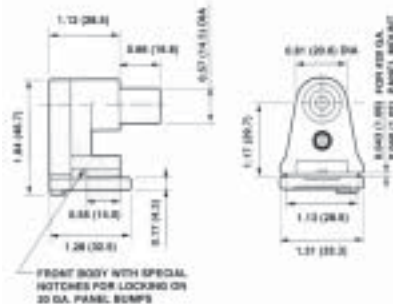

27131
 660W
 600V



CITY LIGHTS INC. Phone: 602 233 2552
 Fax: 602 233 1102
 3911 W Van Buren #3 Phoenix, AZ. 85009 www.citylightsphx.com

2G11 Lampholder: Push Button

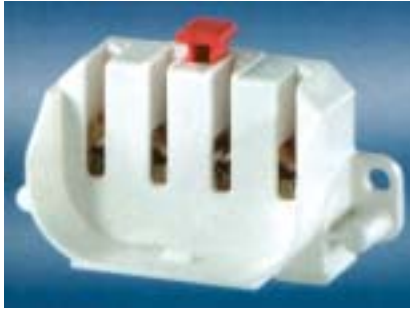

25525 600V 600W

End mount screws

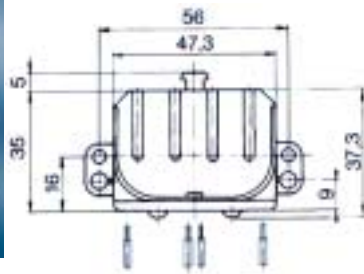

2GX13 Supports for T5 circular Lamps

25510 -snap-in

lamp clip pivots to compensate for lamp tolerances

29113 -screw mount

2G11 Push Button



23661 600V 600W

Horizontal screw mount

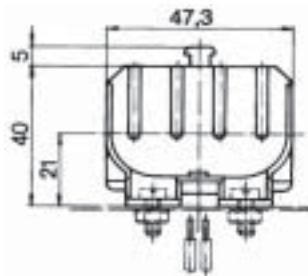

Circline Lamp Connector

660W-600V

Four 12" leads No. 18 AWG, 105dg.C.

29127



2G11 Lampholders

Vertical or horizontal screw mount



23782

23875

End screw mount

Medium Bi-Pin for T-8 & T-12

Thin, rapid-start quickwire

12818

bottom or side wire connectors with release slots

660W-600V

one screw mounting



T2 Lampholders



250V-75W

25565 -screw mount

CITY LIGHTS INC.

3911 W Van Buren #3 Phoenix, AZ. 85009

Phone: 602 233 2552

Fax: 602 233 1102

www.citylightsphx.com

18 Compact Fluorescent Sockets



**4-Pin 10W & 13W
Bottom Screw Mount**



29100 -G24q-1, Gx24q-1

**4-Pin 26, 32, 42W
Bottom Screw Mount**



26138 -G24q-3, Gx24q-4

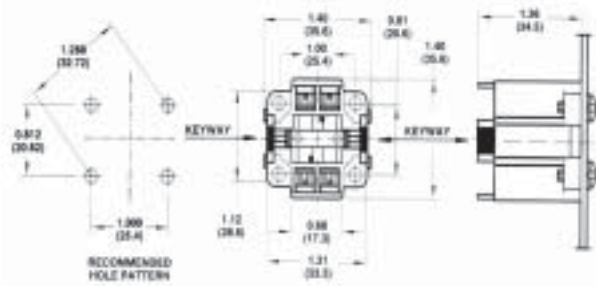

**2-Pin 26W
Bottom Screw Mount**



27114 -G24d-3

**2-Pin 13W
Horizontal Snap-in**

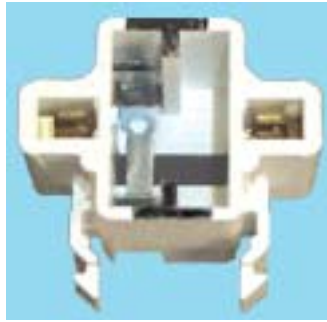

28103 -GX23, GX23-2

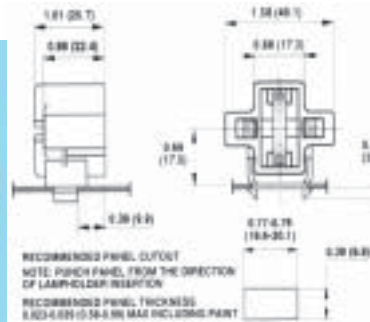

**2-Pin 5, 7, 9W
Horizontal Snap-in**



27148 -G23, G23-2

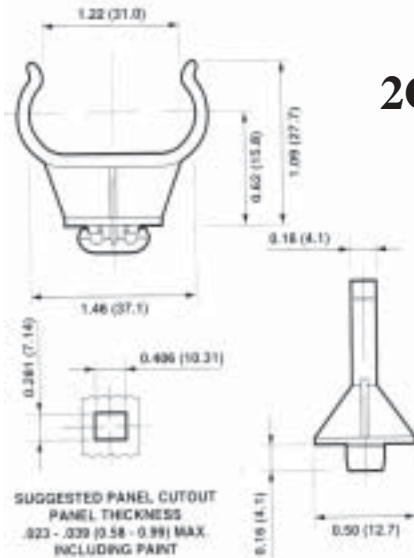

25611 -2G11 plastic support

2G11 Supports



27154 -short(1.31")



28117 - tall(1.45")

Stainless Steel



Horizontal Lamp Support Clip, Short

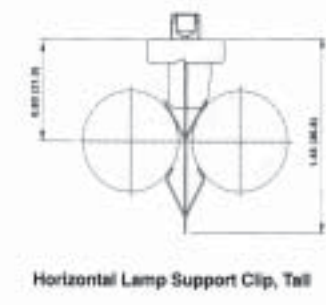

Horizontal Lamp Support Clip, Tall

CITY LIGHTS INC.

Phone: 602 233 2552

Fax: 602 233 1102

3911 W Van Buren #3 Phoenix, AZ. 85009

www.citylightsphx.com

**2-Pin 13W
Horizontal Mount**



26133 -GX23 or GX23-2
GX23-2 requires a .17 spacer

Screw Down Circline



27118 -2GX13

**Vertical Snap-in or
Two Hole Mount**



26113 -2G11

**2-Pin 13W
Two Hole Mount
1.62" Ctr to Ctr**



27102 -Gx23 or GX23-2

panel cutout

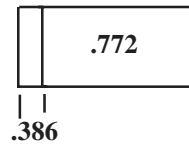

**2-Pin 13W
Horizontal Snap-in**



26129 -GX23 or GX23-2

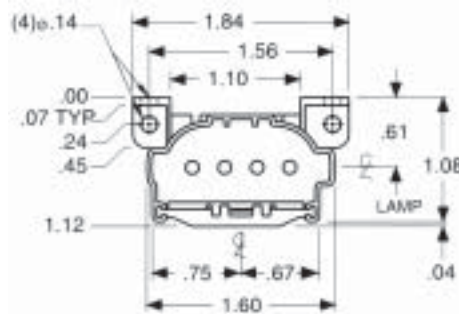

Screw Mount



26122 -2GX7

Plastic Lamp Support

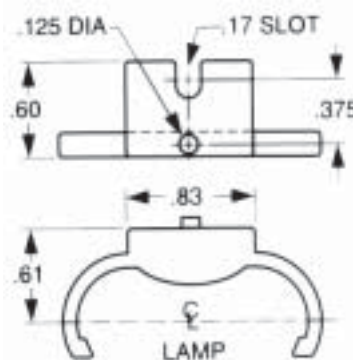

27103 -2G11

**Screw Mount
mounting holes 2.52"**



27127 -2G11

20 Import Sockets



Phenolic Socket

1/8IP hickey, 18" leads
nickel plated screw shell

660W-250V

24165



Pig Tail Type

rubber medium base,
6" leads 660W-250V



23680

Threaded Porc Socket



23683

1/8 IP cap, metal ring,
screw terminals,
nickel plated screw shell

660W-250V

Pin-type Weatherproof Socket



24583 -no hook
29170 -with hook

Rated: 660W-250V

Wire size: 14 or 12 stranded



25615 -intermediate

75W-125V

18 stranded



24555 -candelabra

75W-125V

18 stranded

Phenolic Uno Thread Medium Base

1/8 IP cap

short keyless



660W-250V

Ring included

23684

Candelabra Sockets

Adjustable

3-1/2" to 4-5/8"

1/8 IP

75W-125V

Insulator included



27106 -Leviton
29013 -Import

Solid Hickey
1-3/4" high



27132 -Leviton
23689 -import

Outer Threaded Body

leads: 4-1/2" 18AWG 105°C

75W
125V



27123 -Leviton

Finishing Nut

brown molded plastic



28119

CITY LIGHTS INC. Phone: 602 233 2552
Fax: 602 233 1102

3911 W Van Buren #3 Phoenix, AZ. 85009 www.citylightsphx.com

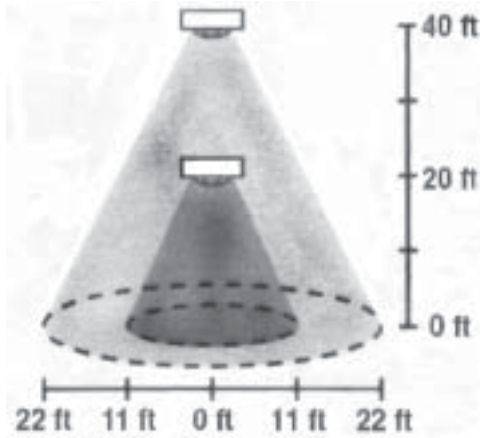

Features:

Sensor type: PIR
 Adjustment: Self-adjusting
 Sensor Technology: Passive infrared
 Pattern Degree: 360
 Coverage Range Sq. Ft.: 1500
 Manual Time Adjustment: 30s-20m
 Load Rating: 800VA@120V,
 1200VA@277V, 1500VA@347V
 Input Volts: 120/277/347VoltsAC
 50/60Hz
 Color: white
 Certification: UL/cUL
 Neutral: Required
 CEC Tile 24 compliance

Leviton High Bay Occupancy Sensor



29335

Trimatron Deluxe Full-Range Rotary Wall Dimmers



29259 -rotary type (white)

29262 -push on/off type
coffee body & ivory knob

600W-120V AC incandescent
 Color-white
 Wire leads
 TV interference filter
 Easy to gang

Motion Activated Wall Switch

Features:

- > 150 degree motion detection angle.
- > Controls 500 total watts incandescent or 400 watts fluorescent lighting with rapid start ballasts.
- > Includes Decora style wall plate.
- > Adjustable daylight shut-off.
- > Variable shut-off delay of 5 seconds to 20 minutes.
- > Slide switch selectable OFF, ON, and Auto modes.
- > Built in photo cell.
- > Coverage from 15' to 30'. 21168

120V AC, 60Hz.

UL listed

color -- white



Full Range Slide Dimmer

Features:

Single-pole
 120V 60Hz. AC
 Color: white
 Low end trim
 adjustment
 TV interference
 filter
 Reliable solid state
 circuitry

29286



CITY LIGHTS INC.

3911 W Van Buren #3 Phoenix, AZ. 85009

Phone: 602 233 2552

Fax: 602 233 1102

www.citylightsphx.com

22 Extensions & Accessories



Swivel Socket Extensions

medium base 2-light

UL Listed
150W max.



27163

medium base

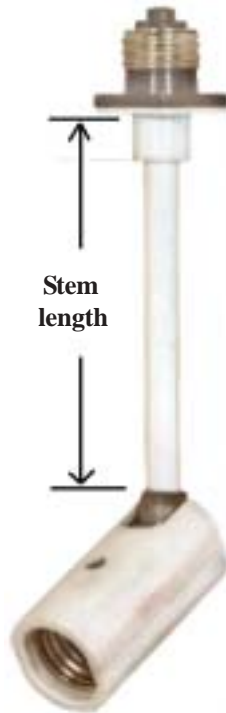

Stem length

23795 -5"
23717 -13"



26091

Candelabra Fiber Drip Cover



29081

Height 4"
ID 3/4"
OD 7/8"

Mogul to Medium Reducer 660W-250V



27105 -Import

25882 -4KV (Leviton)

Candelabra to Medium Enlarger

28114



Medium to Medium Porcelain Extender



22838

660W-250V

Extends 1"

Medium to Medium Phenolic Adapter

extends
1-3/16"



660W
250V

12987

CITY LIGHTS INC. Phone: 602 233 2552

Fax: 602 233 1102

3911 W Van Buren #3 Phoenix, AZ. 85009 www.citylightsphx.com

Connect Stranded and Solid Wire

Fast - Safe - Easy

600 V building wiring
1000 V fixtures and signs
Current rating: Largest conductor used
105° C rated (221° F)



Clear housing allows visual confirmation of connection
Test port for easy continuity testing



File: LR46759



29210

Yellow 2-conductor, 100 pc/box

- 12-16 AWG Stranded Copper (stranding pattern less than or equal to 19)
- 12-18 AWG Solid Copper



29200

Ground 2-conductor, 100 pc/box:

- 12-16 AWG Stranded Copper (stranding pattern less than or equal to 19)
- 12-18 AWG Solid Copper



29125

Orange 4-conductor, 100 pc/box:

- 12-16 AWG Stranded Copper (stranding pattern less than or equal to 19)
- 12-18 AWG Solid Copper



29105

Ground 4-conductor, 100 pc/box:

- 12-16 AWG Stranded Copper (stranding pattern less than or equal to 19)
- 12-18 AWG Solid Copper



29280

LT Grey Special 4-cond. 100pc/box

- 12-16 AWG Stranded Copper (stranding pattern less than or equal to 19)
- 12-18 AWG Solid Copper

(Special opening)

- 18 AWG Stranded Copper (Stranding pattern less than or equal to 16)
- 18 AWG Solid Copper

29220



Box 50

3 Hole for 10 AWG wire



29290

Black 6-conductor, 50pc/box:

- 12-16 AWG Stranded Copper (stranding pattern less than or equal to 19)
- 12-18 AWG Solid Copper



29205

Ground 6-conductor, 50 pc/box:

- 12-16 AWG Stranded Copper (stranding pattern less than or equal to 19)
- 12-18 AWG Solid Copper



29150

Dark Grey 8-conductor, 50pc/box:

- 12-16 AWG Stranded Copper (stranding pattern less than or equal to 19)
- 12-18 AWG Solid Copper



29305

Ground 8-conductor, 50 pc/box:

- 12-16 AWG Stranded Copper (stranding pattern less than or equal to 19)
- 12-18 AWG Solid Copper

3 or 5 Conductor Compact Connector

Cross section: 28 - 12 AWG (stranded and solid)
Electrical specs: 600 V maximum
20 A maximum
Strip length:  9 - 10 mm / 0.37 in
Maximum operating temperature: 105° C

Box 50



29235

Box 40

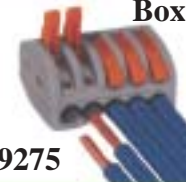

29275

CITY LIGHTS INC.

3911 W Van Buren #3 Phoenix, AZ. 85009

Phone: 602 233 2552

Fax: 602 233 1102

www.citylightsphx.com

24 Wire & Accessories



SPT-2 18/2 Cordsets

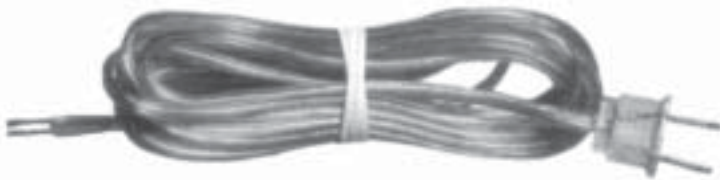

8 feet long with molded plug

- 27142 -silver
- 24512 -white
- 27199 -brown
- 27250 -black
- 24545 -clear gold

250 foot spools



Ground wire 18 ga. 10" long with 8/32 lug



23881

18ga. bare copper wire 250 ft. spool



29110

18/2, SPT-2

- 24368 -clear gold
- 24138 -black
- 23636 -white
- 23811 -brown
- 23965 -clear silver

18/2, SPT-1

- 23485 -clear silver
- 23644 -brown
- 23710 -white
- 23570 -black
- 23657 -clear gold

High Heat Porcelain Connectors



- 29278 2-6#18
- 29285 2-5#18
- 29325 2-4#18

1/8 IP Plastic Pipe Bushing



24511 clear

Spring Loaded Wire Connectors



Pack 100 per box

Part Number	Color	Wire gauge	Voltage	Temp. (C/F)
14560	Grey	22-16	300V	105/221
14533	Blue	22-14	300V	105/221
14593	Orange	22-14	600V	105/221
14808	Yellow	22-14	600V	105/221
14946	Red	18-10	600V	105/221
14720	Black high heat	22-14	300V	150/302
14738	Black high heat	22-16	300V	150/302
14673	Yellow wing	18-10	600V	105/221
14699	Red wing	18-8	600V	105/221

CITY LIGHTS INC. Phone: 602 233 2552

Fax: 602 233 1102

3911 W Van Buren #3 Phoenix, AZ. 85009 www.citylightsphx.com

3-Way, 2 Circuit



25613 -3/8" brass shaft
26092 -5/8" brass shaft
 6A, 125V 3A, 250V

Canopy Push On-Off



25891 -3/8" brass shaft
 3A, 120V 1A, 250V

Rotary Canopy On-Off



26141 -3/8" brass shaft
24565 -5/8" brass shaft
 3A, 250V 6A, 125V

Cord Switch On-Off

18/2 - SPT-2
 6A-125V 3A-250V 3A-125V



27151 -brown
24586 -black
23791 -white

Pull Chain Switch single circuit

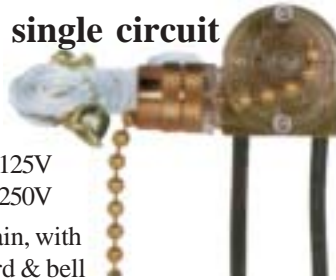

6A-125V
 3A-250V

metal chain, with
 white cord & bell

23667

On/Off Toggle



23699
 6A, 125V 3A, 250V

In Line SPT-2 Rocker Switches for 18/2 3A-120V



Black -29340
 White -29295
 Brown -29321
 Clear -29442

Polarized Slide-on Plug 8A-125V

18/2 SPT-1
23722 -brown
23816 -black
24505 -ivory



18/2-SPT-2
27124 -brown
24717 -black
27165 -ivory

SVT Plastic 2 Piece Strain Relief



23672
 black color

Black Bakelite Bushings



27275
 1/8 IP fem.



24549
 1/8 IP male

CITY LIGHTS INC.

3911 W Van Buren #3 Phoenix, AZ. 85009

Phone: 602 233 2552

Fax: 602 233 1102

www.citylightsphx.com

26 Rope Lighting



SIGNATURE GRADE PREMIUM ROPE LIGHT



Sold on 150 ft. rolls only.

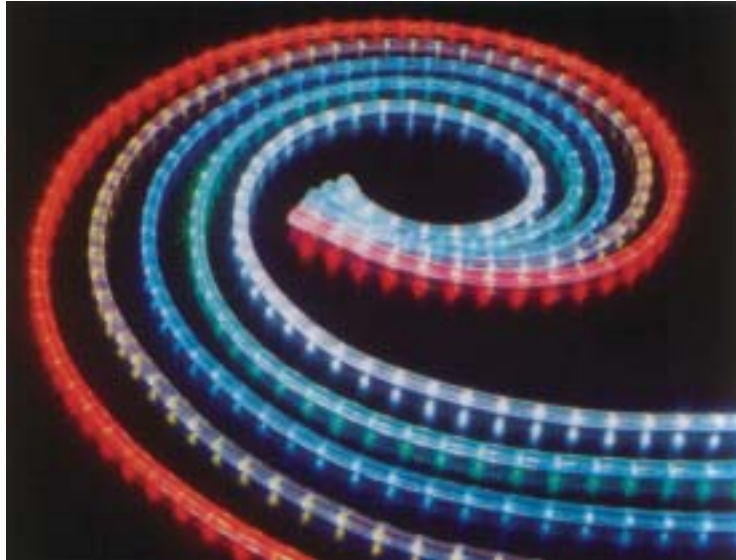

120V AC.
3 watts per foot,
equals 450watts
per 150 ft. roll .
1" bulb spacing.
UL approved.
25,000 hr. bulb life.
Dimmable.
13mm (1/2") diameter.
All colors same price.

Available Colors



Green -23872
Clear -24625
Red -24369
Blue -23787

Accessories:

24513 -Splice.
23798 -5ft. power
cord & connector.
23784 -end cap.
24567 -clips.

Each roll supplied with 3 kits.

Each Kit Includes:

5 ft. power cord
& connector.
end cap.
10 clips.

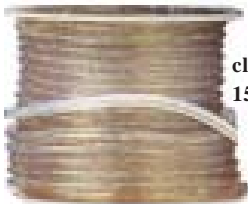
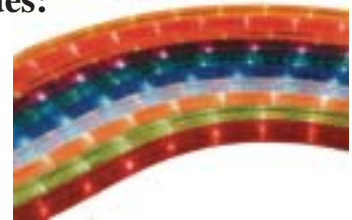

clear rope
150 ft rolls

*Also available our Premium Grade LED rope light.
Call for prices and ship dates. These are special order
items.*

CITY LIGHTS INC. Phone: 602 233 2552
Fax: 602 233 1102

3911 W Van Buren #3 Phoenix, AZ. 85009 www.citylightsphx.com

4" Swivel Type Cover Plate



45° swing

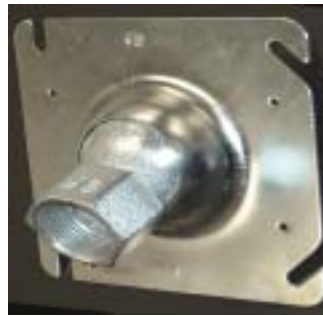

Galvanized steel
Thread 3/4"
Weight limit 75lbs

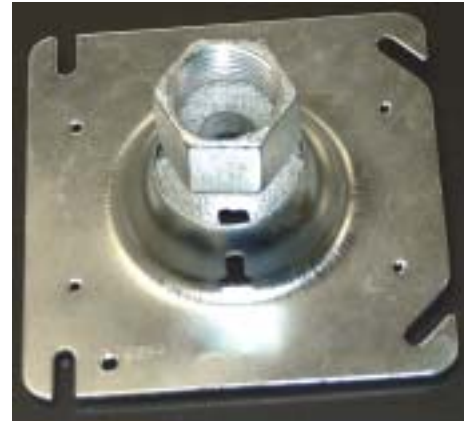

Fits 4" square electrical box **25942**



24708

Bracket Bar + Canopy + 3/8 IPS Ball
Weight limit 50 lbs

24715

Flash Plate + Canopy + 3/8 IPS Ball
Weight limit 75 lbs

Locknut



23674

3/8 IP x 1-1/16" sq.
.073 thick zinc plated

Down Rod for Swivel Canopy Ball 3/8 IPS thread.



24735 -12"

25215 -24"

25237 -48"

24718 -18"

24728 -36"

CITY LIGHTS INC.

3911 W Van Buren #3 Phoenix, AZ. 85009

Phone: 602 233 2552

Fax: 602 233 1102

www.citylightsphx.com

28 HID Ballast Kits & Tester



Kit varies with ballast type, included are: ballast, capacitor, ignitor, bracket, and hardware. Every kit is individually factory tested for quality assurance. Pre-wired capacitor is designed for 60,000 hours of continuous life. Precision wound coils assure even heat dissipation and high electrical integrity. All ballasts are multi-tap 120/208/240/277V. Other ballasts are available on special request.

METAL HALIDE KITS

- 10794 - 50W
- 10496 - 70W
- 10645 - 100W
- 25135 - 150W -M81, M102, M142
- 13423 - 175W -M57, H39, (150W-M107)
- 13572 - 250W
- 13721 - 400W
- 10119 - 1000W
- 14019 - 1500W

We stock a large variety of pulse rated mogul & medium base sockets. HID bulbs and many other accessories are in stock at all times to better serve your needs.

PULSE START KITS

- 13211 - 320W
- 11049 - 400W

Call our customer advisors for help, information & pricing.

HIGH PRESSURE SODIUM KITS

- | Multi-tap | 120 volt only |
|---------------|---------------|
| 12135 - 70W | 13327 - 35W |
| 10647 - 100W | 12880 - 50W |
| 12433 - 150W | 13029 - 70W |
| 11390 - 250W | 12731 - 100W |
| 11539 - 400W | 13178 - 150W |
| 11688 - 1000W | |

HID Tester



- Available in two models
- 20105 -Mogul base up to 1000 watts
 - 20203 -Medium base up to 175 watts

Start with power off: screw in then turn on power! Internal lamps indicate if starter (ignitor) or ballast needs replacement.

Suitable for HID ballast circuit with a starter. Can be used on High Pressure Sodium, Metal Halide, and Mercury Vapor. Checks starting pulse voltage and open circuit voltage.

CITY LIGHTS INC. Phone: 602 233 2552
Fax: 602 233 1102

3911 W Van Buren #3 Phoenix, AZ. 85009 www.citylightsphx.com

All chain sold in 1 yard lengths



#8 Flat Black
23642

#8 White
23741

#8 Ready to Paint
23775

#8 Nickel
23712

#8 Pol. Brass
23631

#8 Ant. Brass
23837

#4 Flat Black
23890

#4 Ready to Paint
23841

#4 Nickel
23650

#4 Pol. Brass
23701

#4 Ant. Brass
23567

We're really up tight about our chain.

We have no weak links.

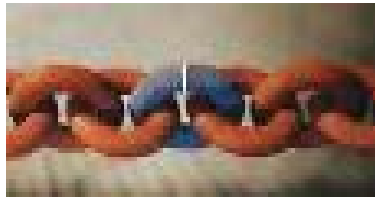

Connecting Links



Zinc plated

23706 -1/4" -load 880 lbs.

23655 -3/16" -load 615 lbs.

23690 -1/8" -load 220 lbs.

Heavy Duty Malleable Iron Chain Pliers

For use with #10, 11, 8, or 4 gauge chain

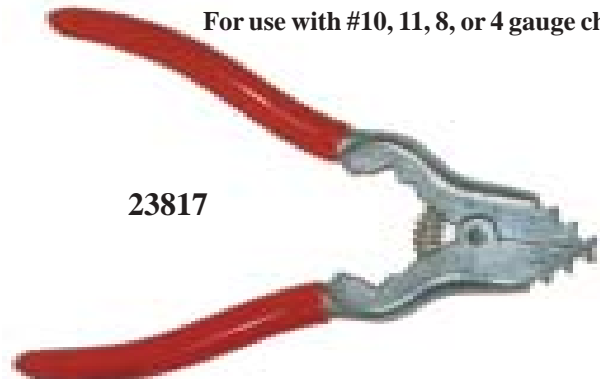

23817

Solid Brass Hang Straight Swivel

1/4F x 1/4F

Ring nut seats 1-1/16"

Height 1-1/2"



28230

CITY LIGHTS INC.

3911 W Van Buren #3 Phoenix, AZ. 85009

Phone: 602 233 2552

Fax: 602 233 1102

www.citylightsphx.com

30 Halogen Sockets



Universal Type Halogen Sockets

G4,G5.3,G6.35 Rating: 250V-750W

G4, G5.3, G6.35 Rating: 250V-750W

G4, G5.3, G6.35
Rating: 250V-750W

18" SF-1 200°C leads



23678 18" SF-1 200°C leads



1/8 IP hickey

18" SF-1 200°C leads 23880



24364

Minican Socket

250V-1000W 25570

E11 base



18" SF-1 leads

Minican Socket

250V-1000W

18" SF-1 leads



E11 base

25515

GX5.3-GX6.35

14" high temp leads



26089 250V-750W

Wedge Base Socket



23639 125V-75W

Halogen with Aluminum Polished Heat Sink

G5.3 (MR-16)

23568

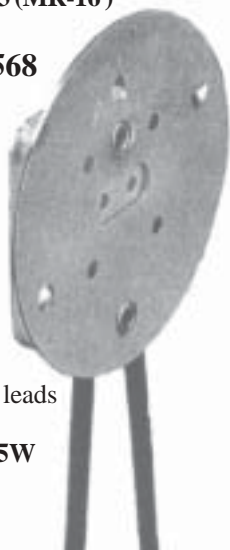

6" SF-2 leads

125V-75W

Quartz Halogen Socket

Lamp base R7S 118MM

250V-1000W



23643

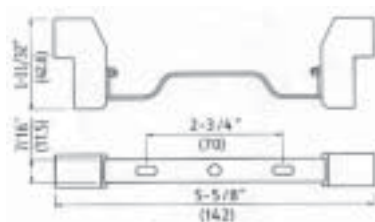

Bayonet Socket Double Contact Quartz Halogen with Bracket



22934

125V-500W

CITY LIGHTS INC. Phone: 602 233 2552
 Fax: 602 233 1102
 3911 W Van Buren #3 Phoenix, AZ. 85009 www.citylightsphx.com